

**180 Apartment Units**  
 ( 20 & 40 Unit Buildings )  
 Add 20 3BR Townhomes  
**200 Units Total**

**333 Parking Spaces and Garages**  
**12,000 sq.-ft. Retail**

ARCHITECT'S SITE PLAN  
 SCALE: 1/8" = 1'  
**Rev. 11-26-18**

*red 11/29/18*

24 Units  
3 Story Bldg.

HOUSE  
GARAGE

**Essex Pastures**  
 Ipswich, MA  
 November 26, 2018

**The MZO GROUP**  
 DESIGNERS • ARCHITECTS • PLANNERS  
 IN THE MERRILL TALENTION

355 Main Street, Suite 201 • Ipswich, Massachusetts 01938  
 Voice: 781-279-4446 • Fax: 781-279-4448 • E-Mail: [info@mzogroup.com](mailto:info@mzogroup.com) • [www.mzogroup.com](http://www.mzogroup.com)

**Sheet A-1**

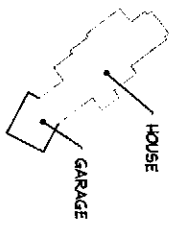
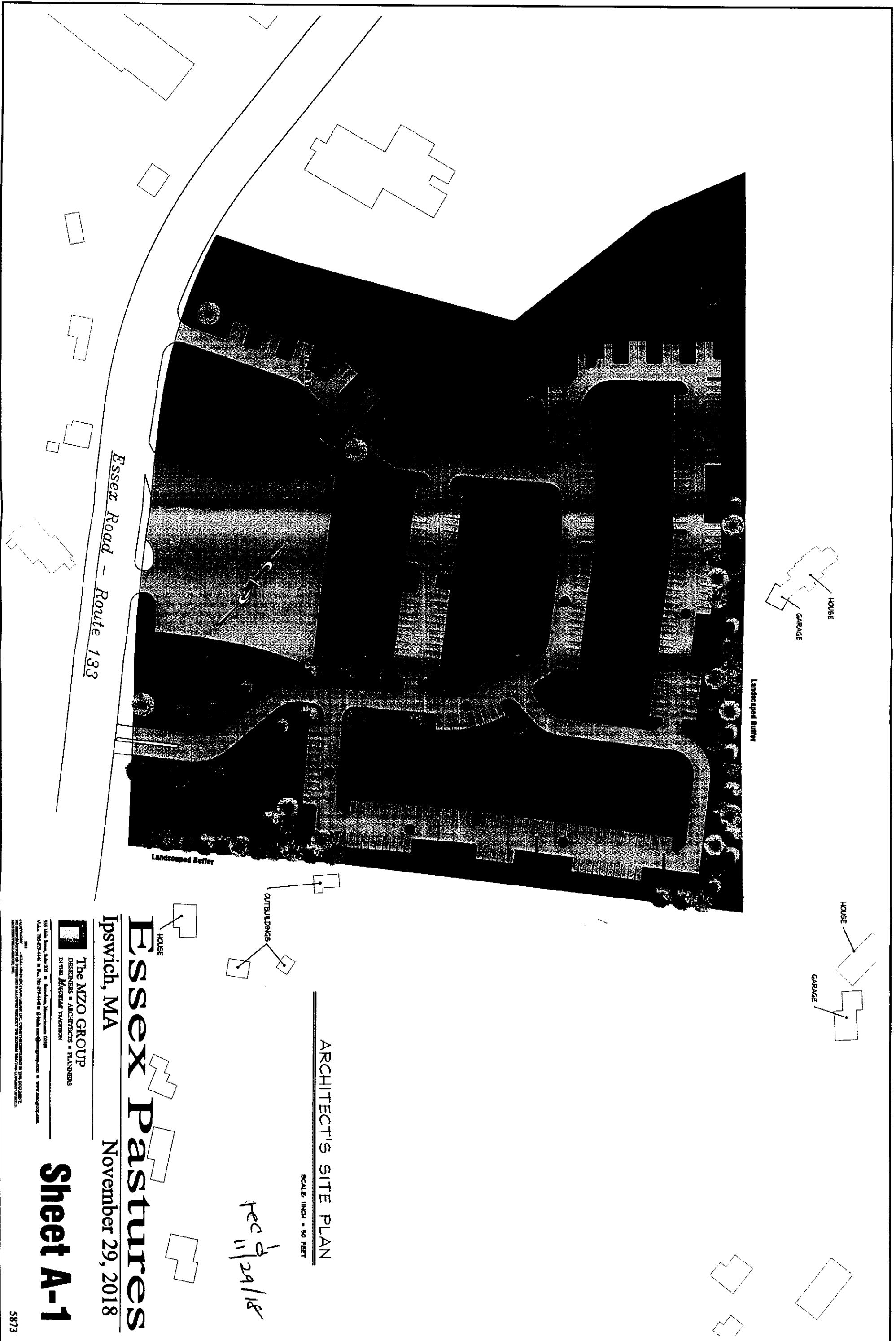

Landscaped Buffer

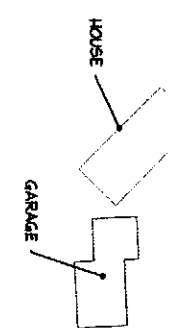

Essex Road - Route 133

Landscaped Buffer

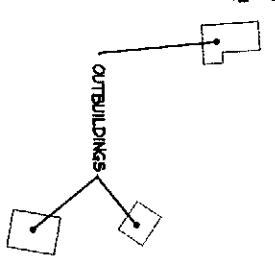

ARCHITECT'S SITE PLAN

SCALE: 1/8" = 10 FEET

REC'D 11/29/18

Essex Pastures  
Ipswich, MA  
November 29, 2018

The MZO GROUP  
DESIGNERS • ARCHITECTS • PLANNERS  
IN THE MERRIMACK VALLEY

355 Lake Street, Suite 201 • Southbury, Vermont 05488  
Phone: 781-273-7446 • Fax: 781-273-7448 • Email: [info@mzogroup.com](mailto:info@mzogroup.com) • [www.mzogroup.com](http://www.mzogroup.com)

Sheet A-1